

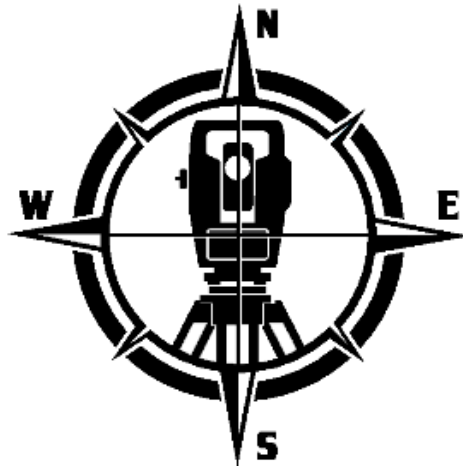

**SWAMI KESHVANAND INSTITUTE OF TECHNOLOGY
MANAGEMENT & GRAMOTHAN, JAIPUR**

DEPARTMENT OF CIVIL ENGINEERING

B.Tech. 3rd Semester



Survey Camp Report

(Session 2025-26)

Location

Pooth ka Bas, Chandwaji, Jaipur

Latitude 27°11'56.30"N

Longitude 75°54'6.49"E

(28 October to 2 November 25)

Survey Camp Coordinator

Mr. Ankur Mishra, Mr. Nikhil Kumar Sharma

1. Introduction

1.1 Overview

Surveying is a fundamental aspect of Civil Engineering that serves as the basis for planning, designing, and executing various infrastructure projects. To bridge the gap between theoretical knowledge and practical implementation, the Department of Civil Engineering organized a Survey Camp for 4th semester students from 28th October to 2nd November 2025 at Pooth ka Bas, Chandwaji, Jaipur. The geographical coordinates of the site are Latitude $27^{\circ}11'56.30''\text{N}$ and Longitude $75^{\circ}54'6.49''\text{E}$. This field training was a vital component of the academic curriculum and aimed to provide students with practical exposure to various surveying techniques including topographic survey, profiling and cross-section levelling, and contour mapping. The camp allowed students to apply their classroom knowledge in a real-world setting, develop essential technical skills, and understand the challenges encountered during fieldwork.

1.2 Objectives of the Survey Camp

The main objectives of conducting the survey camp were:

- A. To provide hands-on training in modern and conventional surveying techniques.
- B. To develop skills in operating surveying instruments such as dumpy levels, theodolites, total stations, and leveling staff.
- C. To understand the methodologies involved in topographic surveying, longitudinal and cross-sectional levelling, and contour map preparation.
- D. To encourage teamwork, leadership, time management, and data interpretation abilities among students.
- E. To expose students to real terrain conditions and field data collection challenges.

1.3 Location Details

The camp was conducted in a semi-rural terrain at Pooth ka Bas, Chandwaji, situated near Jaipur, Rajasthan, 66 KM from the institute. The area provided an ideal mix of natural undulations and man-made features for carrying out diverse survey activities. The open landscape facilitated practical learning and helped students understand the significance of survey data in construction planning and site development.

1.4 Importance of Surveying in Civil Engineering

Surveying plays a crucial role in the planning and execution of civil engineering projects such as highways, bridges, dams, and buildings. Accurate survey data forms the basis for design, estimation, and construction. The camp helped students appreciate the real-world applications of surveying and understand the precision and diligence required for successful fieldwork.



2. Activities Conducted

The key activities performed during the camp were:

- Topographical Survey – Measuring and mapping the surface features of the land.
- Profiling and Cross-Section Levelling – Determining elevation changes along specific lines and across selected sections.
- Contour Mapping – Preparing contour maps by plotting points of equal elevation to represent the terrain.
- Trigonometric Levelling – To calculate the height of a land feature, when base is not accessible.

Daysc	Day 1	Day 2	Day 3	
Groups			Activity1	Activity2
G1	TP 1	PL1	C1	TR1
G2	TP 2	PL2	C2	TR2
G3	TR1	TP 1	PL1	C1
G4	TR2	TP 2	PL2	C2
G5	C1	TR1	TP 1	PL1
G6	C2	TR2	TP 2	PL2
G7	PL1	C1	TR1	TP 1
G8	PL2	C2	TR2	TP 2

Abbreviation

TP 1	Typography surveys 1
TP 2	Typography surveys 2
TR 1	Trigonometric 1
TR 2	Trigonometric 2
C 1	Contour 1
C 2	Contour 2
PL 1	Profile Leveling 1
PL 2	Profile Leveling 2

3. Students and Faculties Participation

Group 1	Group 2	Group 3	Group 4	Group 5	Group 6	Group 7	Group 8
Aman Choudhary	Abhishek Kanwat	Himanshu Ahlawat	Keshav Kumawat	Kamlesh kr Joya	Devesh	Hiren Patidar	Jatin Sattawan
Gaurav Shekhawat	Ayush Meena	Gaurav Bhadoo	Aditya Kudaliya	Daksh Bamnawat	Aditya Upadhyay	Daksh Kasniwal	Hemant Kumar
Dheeraj Meena	Amisha	Irshad Ali	Deepak Rajalwal	Harshit Verma	Aman Sinsinwar	Akshay Choudhary	Krishna Gupta
Kapil Saini	Divya	Doyal	Aryan Palsaniya	Hemant Saini	Dhruv Rawat	Anshu	Divyansh Chhawal
Kartikeya Singh Bhati	Khushi	Ayushi	Jeetendra Saini	Mridul Gaur	Kush Sharma	Aryan Kadhala	Dinesh
Gulshan Lamba	Janshi	Komal	Mohit Kayat	Kartikey Kumar	Krish Nagarwal	Jitendra Chaudhary	Mohammad Anas Khan
Ashwini Modi	Ankit Kumar Meena	Aryan Sharma		Aditya Meena	Aditya Barwal	Mohd Irfan	Himanshu
Dayashankar		Ashish Kumar					

Faculty Members Assigned for Survey Camp: From 28/10/25 to 2/11/25

Day	Name of Faculty	Date
1.	Ankur Mishra Nikhil Kumar Sharma Dr. Aditi Deepak Sharma Prahlsad Kumar Lal Chand Swami	28 Oct 2025
2.	Ankur Mishra Nikhil Kumar Sharma Sitaram Saini Akash Johari Leena Narula Prahlad Kumar Lal Chand Swami	29 Oct 2025

3.	Ankur Mishra Nikhil Kumar Sharma Akash Johari Deepak Sharma Prahlad Kumar Leena Narula Lal Chand Swami	30 Oct 2025
4.	Ankur Mishra Nikhil Kumar Sharma Dr. Abhishek Jain Dr. J.K.Vyas Leena Narula Prahlad Kumar Anil Sharma	31 Oct 2025
5	Ankur Mishra Nikhil Kumar Sharma Dr. Abhishek Jain Pawan Patidar Leena Narula Prahlad Kumar Anil Suryvanshi	1 Nov. 2025
6	Ankur Mishra Nikhil Kumar Sharma Akash Johari Leena Narula Prahlad Kumar Anil Suryvanshi	2 Nov. 2025 (Sunday)

4. Output by the students

Topographic Map of temple site

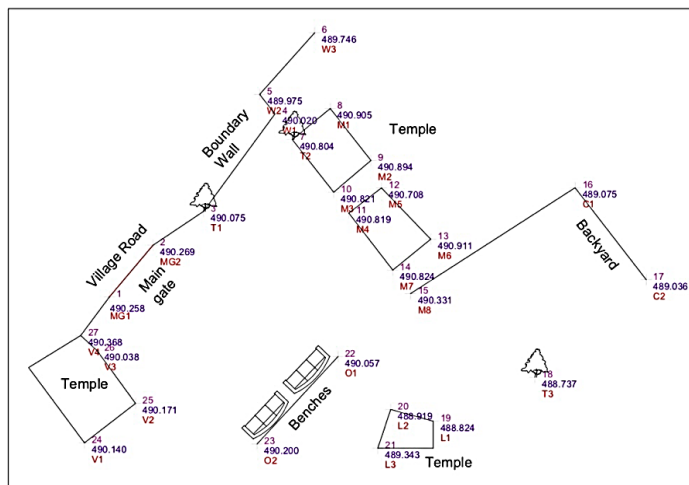

Topographic Map of temple site

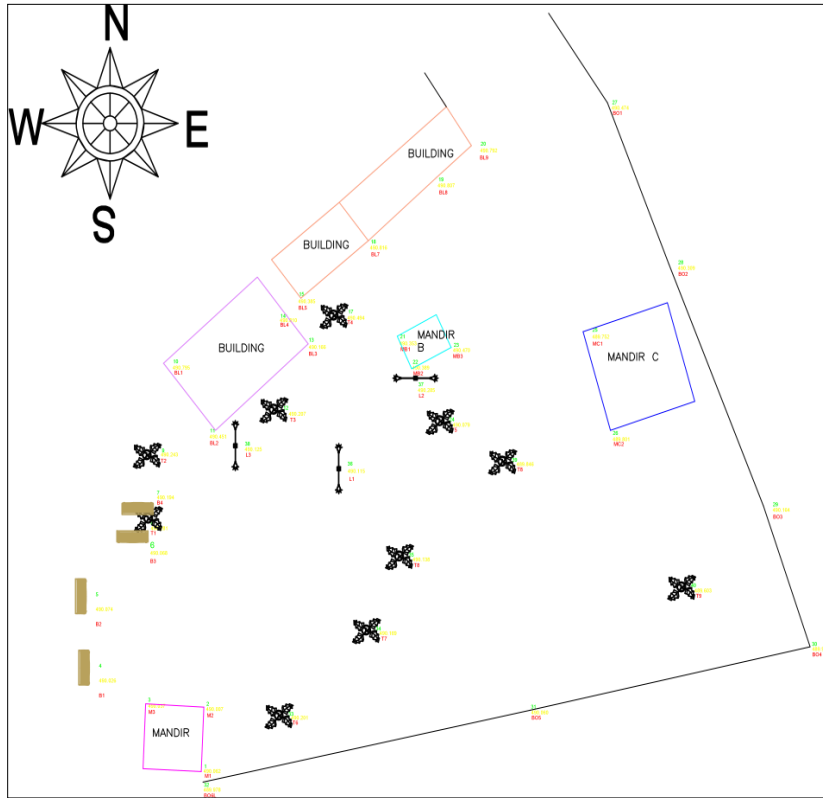

Longitudinal Profile Curve

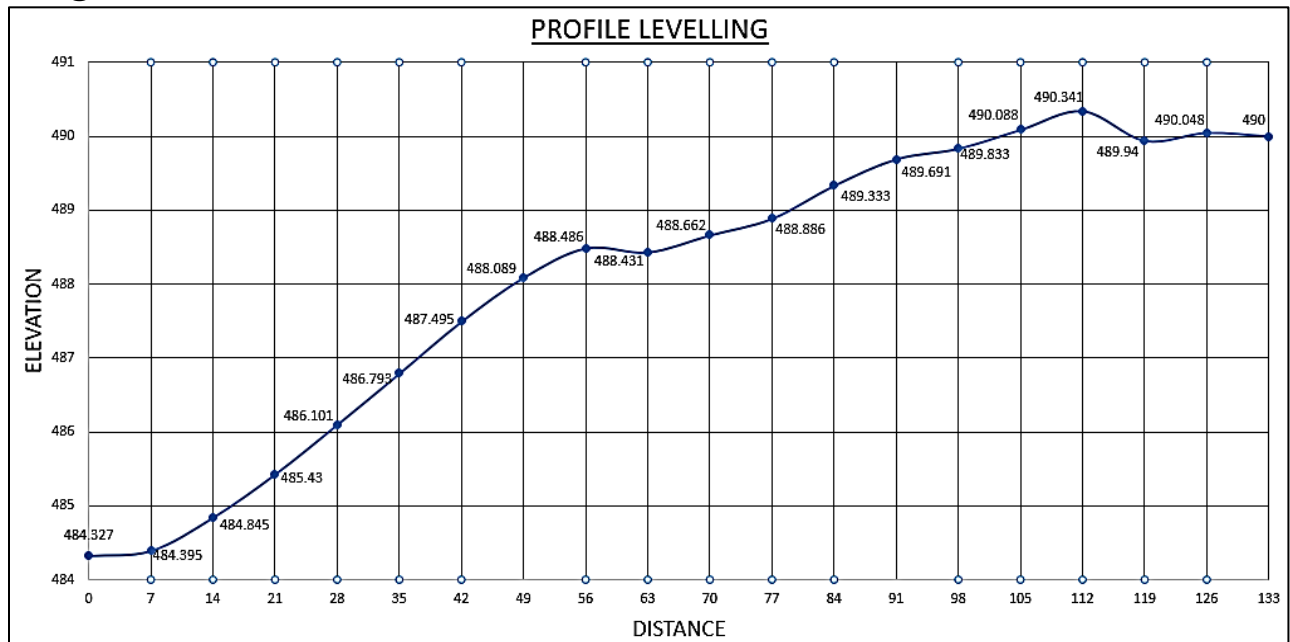

Pictures







Survey Camp Coordinator

 **Ankur Mishra, Nikhil Kumar Sharma**