

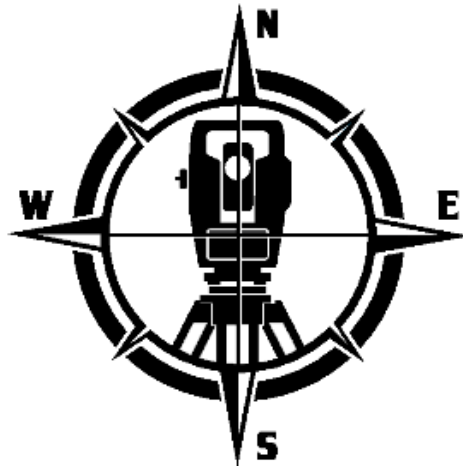

**SWAMI KESHVANAND INSTITUTE OF TECHNOLOGY
MANAGEMENT & GRAMOTHAN, JAIPUR**

DEPARTMENT OF CIVIL ENGINEERING

B.Tech. 4th Semester



Survey Camp Report

(Session 2024-25)

Location

Pooth ka Bas, Chandwaji, Jaipur

Latitude 27°11'56.30"N

Longitude 75°54'6.49"E

(28 Feb 25 to 5 March 25)

Survey Camp Coordinator

Mr. Ankur Mishra, Mr. Gaurav Gupta

1. Introduction

1.1 Overview

Surveying is a fundamental aspect of Civil Engineering that serves as the basis for planning, designing, and executing various infrastructure projects. To bridge the gap between theoretical knowledge and practical implementation, the Department of Civil Engineering organized a Survey Camp for 4th semester students from 28th February to 5th March 2025 at Pooth ka Bas, Chandwaji, Jaipur. The geographical coordinates of the site are Latitude $27^{\circ}11'56.30''\text{N}$ and Longitude $75^{\circ}54'6.49''\text{E}$. This field training was a vital component of the academic curriculum and aimed to provide students with practical exposure to various surveying techniques including topographic survey, profiling and cross-section levelling, and contour mapping. The camp allowed students to apply their classroom knowledge in a real-world setting, develop essential technical skills, and understand the challenges encountered during fieldwork.

1.2 Objectives of the Survey Camp

The main objectives of conducting the survey camp were:

- A. To provide hands-on training in modern and conventional surveying techniques.
- B. To develop skills in operating surveying instruments such as dumpy levels, theodolites, total stations, and leveling staff.
- C. To understand the methodologies involved in topographic surveying, longitudinal and cross-sectional levelling, and contour map preparation.
- D. To encourage teamwork, leadership, time management, and data interpretation abilities among students.
- E. To expose students to real terrain conditions and field data collection challenges.

1.3 Location Details

The camp was conducted in a semi-rural terrain at Pooth ka Bas, Chandwaji, situated near Jaipur, Rajasthan, 66 KM from the institute. The area provided an ideal mix of natural undulations and man-made features for carrying out diverse survey activities. The open landscape facilitated practical learning and helped students understand the significance of survey data in construction planning and site development.

1.4 Importance of Surveying in Civil Engineering

Surveying plays a crucial role in the planning and execution of civil engineering projects such as highways, bridges, dams, and buildings. Accurate survey data forms the basis for design, estimation, and construction. The camp helped students appreciate the real-world applications of surveying and understand the precision and diligence required for successful fieldwork.



2. Activities Conducted

The key activities performed during the camp were:

- Topographical Survey – Measuring and mapping the surface features of the land.
- Profiling and Cross-Section Levelling – Determining elevation changes along specific lines and across selected sections.
- Contour Mapping – Preparing contour maps by plotting points of equal elevation to represent the terrain.

Group	Day-1	Day-2		Day-3
		1st shift	2nd shift	
G-1	TP-1	CONT	CL-1	PL-1
G-2	TP-2	CONT	CL-2	PL-2
G-3	CONT	TP-1	CL-3	PL-3
G-4	CONT	TP-2	CL-4	PL-4
G-5	PL-1	CL-1	TP-1	CONT
G-6	PL-2	CL-2	TP-2	CONT
G-7	PL-3	CL-3	CONT	TP-1
G-8	PL-4	CL-4	CONT	TP-2

Abbreviation

TP = Topography survey

CONT = Contouring

PL = Profile levelling

CL = Cross-section Levelling





3. Students and Faculties Participation

All the students are divided into 8 groups.

Section A

Group 1	Group 2	Group 3	Group 4	Group 5	Group 6	Group 7	Group 8
Aditya Sharma	Aman Kumar Pandey	Dhruv Sehgal	Himanshu Saini	Aditya Khandelwal	Manisha Sharma	Lokesh Kumar Meena	Govind Choudhary
Abhay Pokhariya	Abu Sufiyan	Divyansh Sharma	Diksha	Aditya Yadav	Kalpesh Dewanda	Jatin Chhabra	Hariom Sarswat
Abhishek Chandel	Aditya Beniwal	Garv Galhotra	Dinesh Kumar	Ajay Raj	Manish Buri	Jitendra Choudhary	Harsh Badgurjar
Anil Gurjar	Aditya Garg	Gaurav Jangir	Divya Sharma	Aman Kumar	Honey Gill	Kapil Kumar	Harshini Gupta
Aditya Raj Shekhawat	Anjali Sharma	Hemant Kumar Meena	Divyanshu Saini	Anushka Meena	Mahima Choudhary	Kapil Meena	Chhaya
Ankit Choudhary	Bhumika Yogi	Deepak Kumar Bairwa	Himanshu Saugat	Anushka Sharma	Manish Kumar Mina	Karan Singh	Happy Gill
Anmol Bishnoi	Arvind Dhanaram Choudhary	Devendra	Mayank Sharma	Anish Kumar	Manish Saini	Keshav Pandit	Harshit Parmar
Meena Nitinkumar Lakhanlal		Dhruv Beadwal	Kunal Saugan	Kuldeep Gurjar	Lisha khandelwal	Lavish Vijay	Lakshya Foujdar

Section B

Group 1	Group 2	Group 3	Group 4	Group 5	Group 6	Group 7	Group 8
Priyanka Lomror	Pranjal Beniwal	Puneet Kumar Sulaniya	Shashank Jangid	Shubham Aloria	Samyak Jain	Tanishq Gupta	Yuvraj Singh Jadaun
Mohd Momeen Khan	Mohd Shafiq	Mohd Tabish Siddiqui	Pushpendra Singh Tanwar	Rahul	Rameshwar Choudhary	Sonu Umarwal	Siddharth Lawaniya
Naina Singh	Neha Choudhary	Piyush Khajotiya	Rahul Meena	Rameshwar Choudhary	Raunak Subedar	Sunil Kumar	Sumit Bharti
Nihal Saxena	Nitish Kumar Meena	Pragya Sharma	Rawal Singh	Ridam Bagari	Rishi Raj Singh Nathawat	Utkarsh Meena	Sumit Meena
Prakhar Khora	Payal Meena	Priyanshu Gautam	Rohit Harsana	Rohit Meena	SACHIN GURJAR	Vaijayant Verma	Tarun Kumar Meena
Priyanshu Kasana	Priyanshu Bhabla	Priyanshu Kasana	Sachin Yadav	Sanidhya Bhardwaj	Shashi Raj Bhabla	Vidushi Sarva	Vishal Yadav
Tanul Badiwal	Priyanshu Kumawat	Chinmay Kumawat	Shubham Singhal	Shubhangi Mudgal		Yash Singh	Vishu Thakur

Faculty Members Assigned for Survey Camp: From 28/2/25 to 5/3/25

Day	Name of Faculty	Date
1.	Ankur Mishra Gaurav Gupta Nikhil Kumar Sharma Leena Narula Prahlad Kumar Suresh Yadav	28/2/25
2.	Ankur Mishra Gaurav Gupta Nikhil Kumar Sharma Prahlad Kumar Suresh Yadav	1/3/25
3.	Ankur Mishra Gaurav Gupta Prahlad Kumar Suresh Yadav	2/3/25 (SUNDAY)
4.	Ankur Mishra Gaurav Gupta Leena Narula Prahlad Kumar Suresh Yadav	3/3/25

5	Ankur Mishra Gaurav Gupta Rakesh Choudhary Leena Narula Prahlad Kumar Suresh Yadav	4/3/25
6	Ankur Mishra Gaurav Gupta Rakesh Choudhary Pooja Gupta Leena Narula Prahlad Kumar Suresh Yadav	5/3/25

4. Output by the students

Topographic Survey (Group 1, section B)

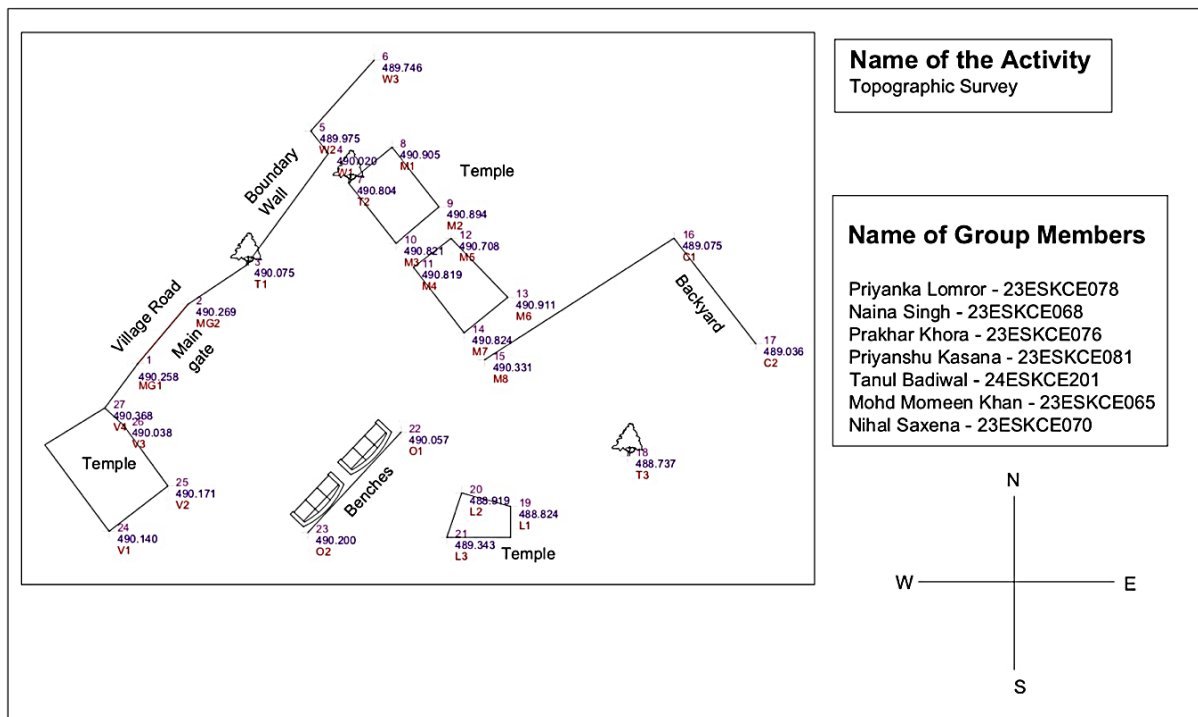

Contour Map (Group 1, section B)

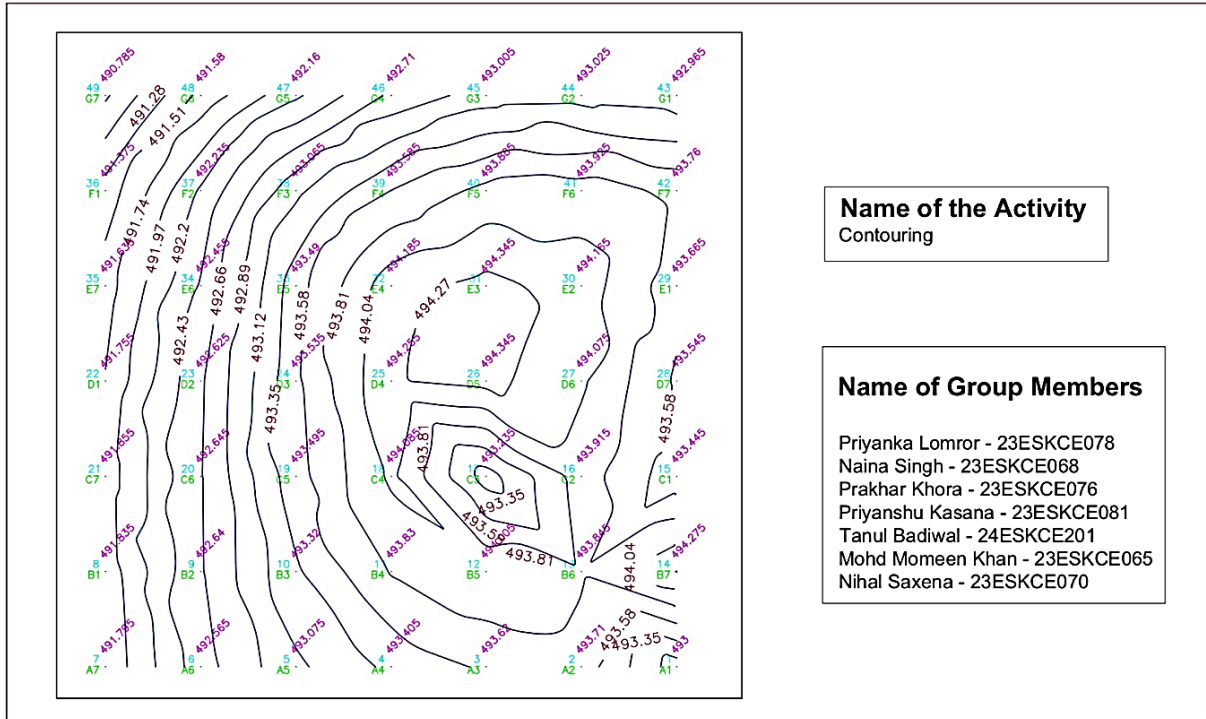

Longitudinal Profile Curve (Group 4, section A)

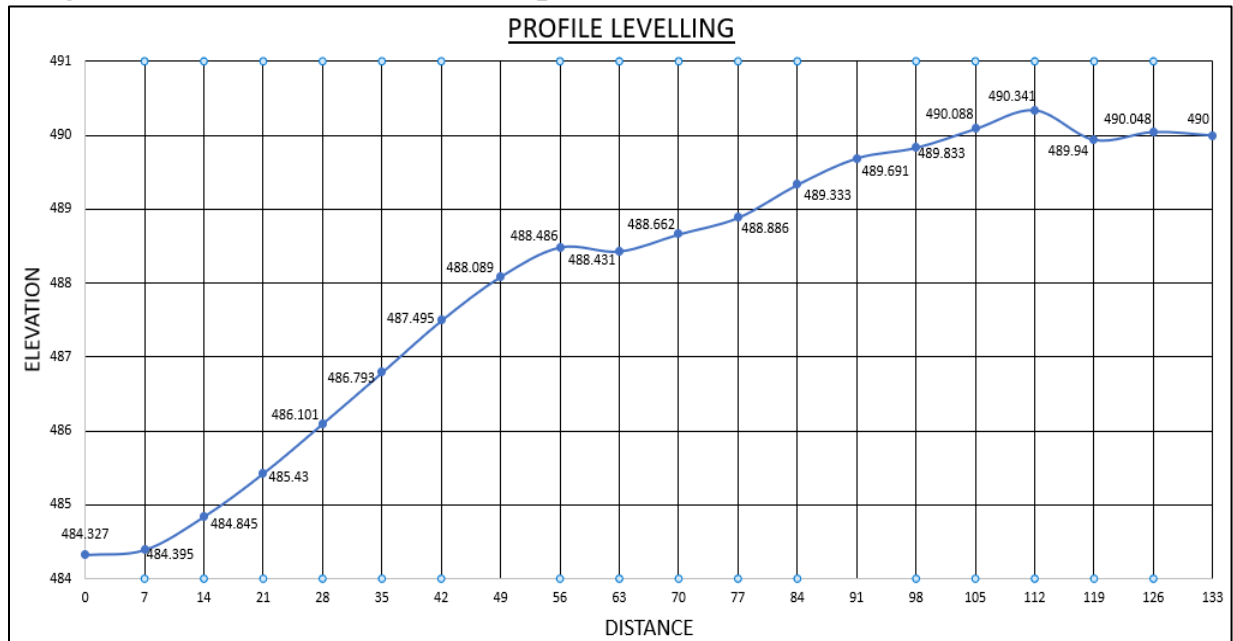

Cross-sectional Profile curve (Group 4, section A)

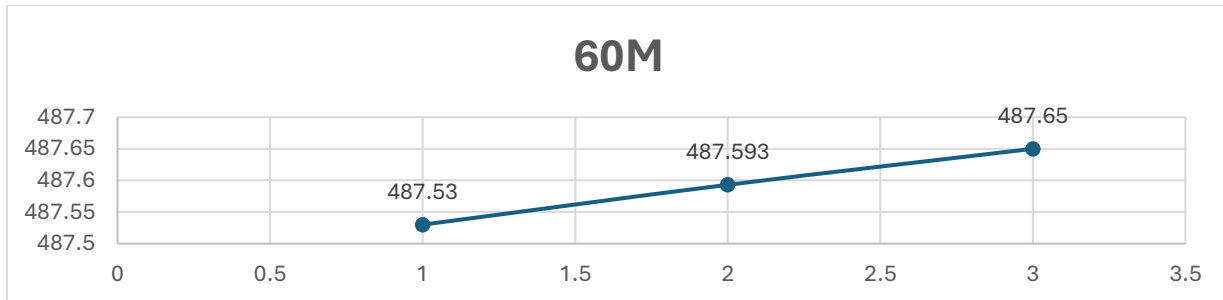
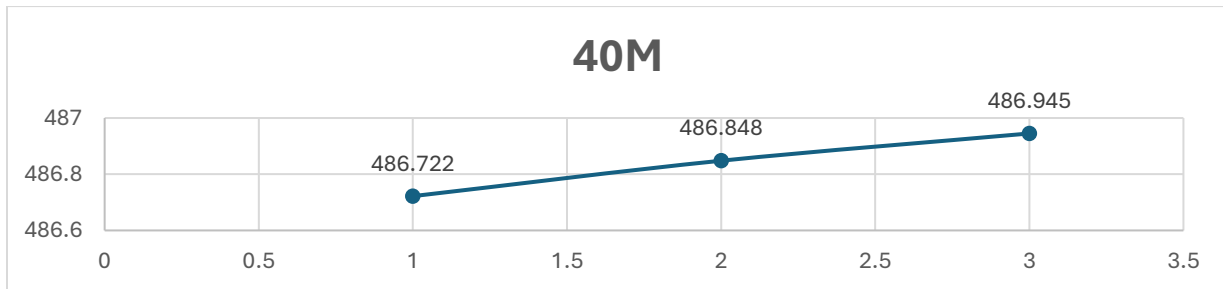
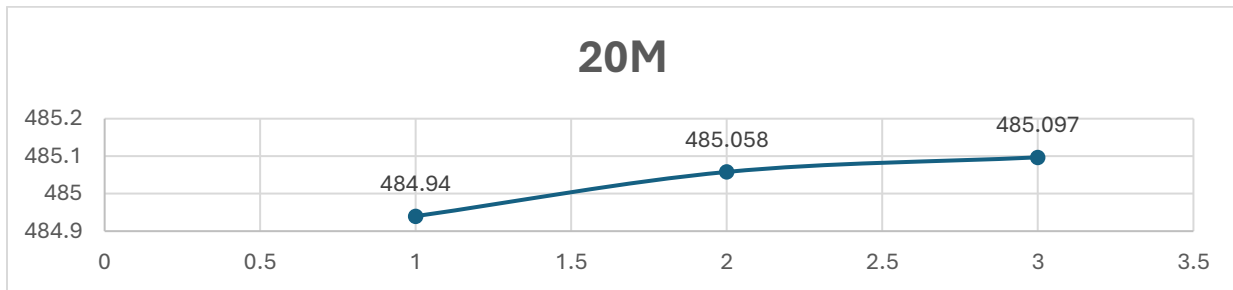
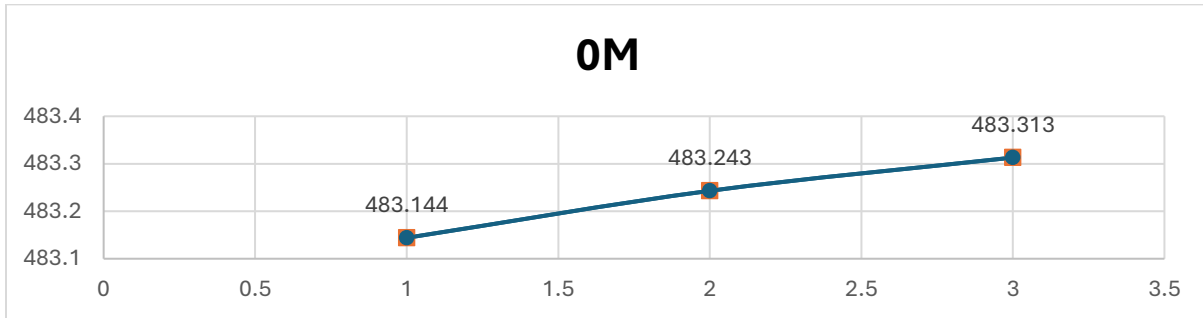

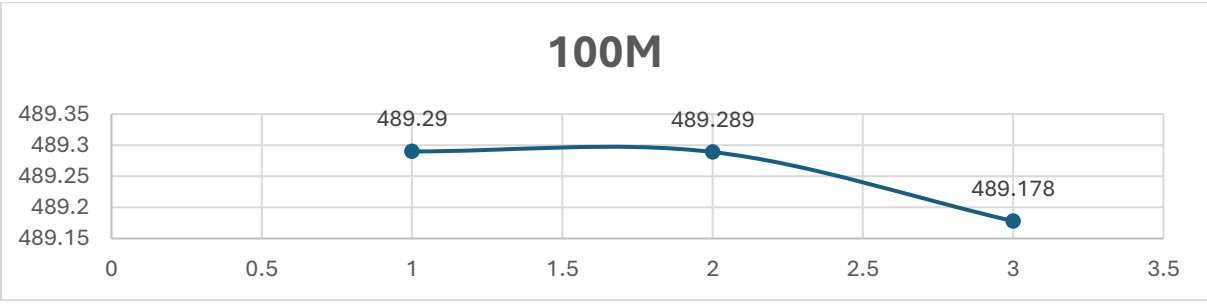
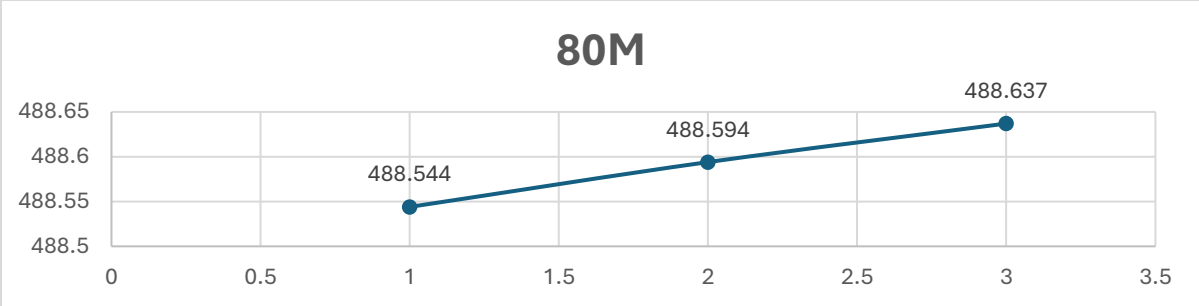

Glimpse of Survey Camp







Survey Camp Coordinator
Ankur Mishra
Gaurav Gupta